

STAGE *your* STORY

CRAFTING HISTORIC EVENTS FOR MODERN TRIUMPHS

Anchoring the city's downtown, Hotel Cleveland offers an unmatched blend of historic charm and modern amenities, tailored to both leisure and business travelers. Known affectionately as the Grand Dame of Cleveland, it redefines luxury with spaces that invite relaxation and innovation with state-of-the-art meeting facilities. Here, every visit is infused with genuine character, transforming each gathering into a memorable chapter of Cleveland's ongoing narrative. Beyond a century-old haven, Hotel Cleveland is a hub where stories unfold and connections are made, mirroring the city's relentless spirit and welcoming heart.

HOTEL CLEVELAND HIGHLIGHTS

THE EXPERIENCE || Timeless elegance fuses with contemporary style in the heart of downtown Cleveland

ROOMS || 491 guest rooms including 50 suites, artfully crafted to reflect our storied heritage

DINING & DRINKS || Maker: shareable dishes & show-stopping cocktails • Mowrey's: breakfast & brunch • Private dining • Catering

MEETING HIGHLIGHTS || 60,000+ sq ft of versatile meeting space • One of the largest ballrooms in the state of Ohio
Two historic, original stages • Three main ballrooms and 20+ breakout rooms • Sophisticated, historical ambiance

LOCATION || 10 min walk to the convention center • In the heart of downtown with over 50 dining and entertainment options within walking distance

HOTEL
CLEVELAND
EST. 1918

HOTEL CLEVELAND

EST. 1918

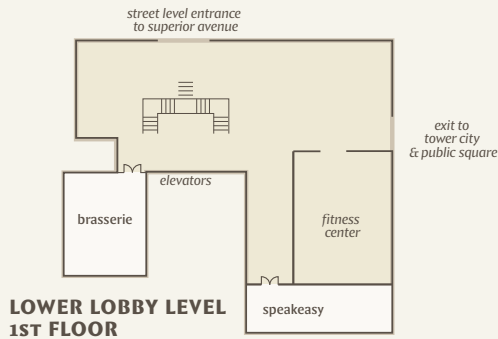

LOBBY LEVEL 2ND FLOOR

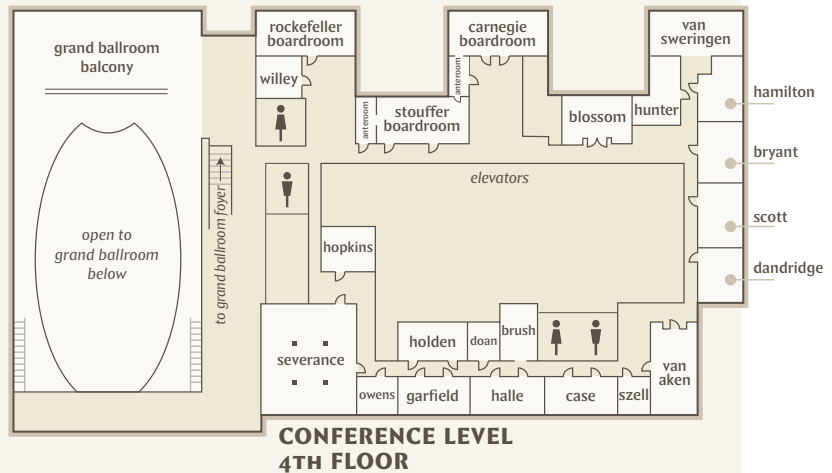
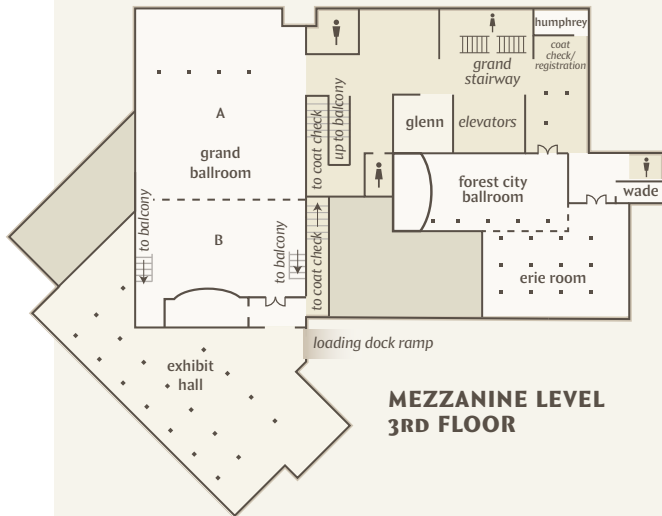
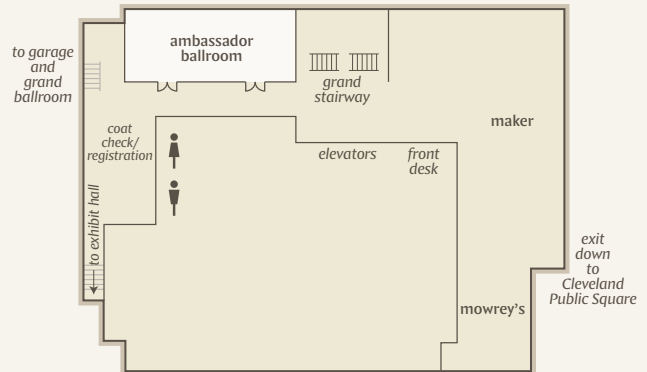

MEZZANINE LEVEL 3RD FLOOR

CONFERENCE LEVEL 4TH FLOOR

	square feet	theater	classroom	conference	u-shape	reception	banquet
LOBBY LEVEL (2ND FLOOR)							
Ambassador Ballroom	3293	450	240	80	60	400	300
MEZZANINE LEVEL (3RD FLOOR)							
Grand Ballroom	22590	1750	500	—	—	2300	1350
Grand Ballroom A	9090	850	300	80	76	1200	600
Grand Ballroom B	5400	450	200	64	64	500	250
Grand Ballroom A&B	14490	1500	500	—	—	1700	850
Grand Ballroom Balcony	8100	250	—	—	—	600	500
Exhibit Hall	11000	500	150	—	—	700	770
Forest City & Erie	9752	600	320	—	—	900	660
Forest City Ballroom	5600	600	270	80	60	600	390
Erie Room	4152	150	50	42	76	450	270
Glenn	1050	85	50	34	30	100	60
Wade	494	30	16	16	20	50	20
Humphrey	666	60	10	28	26	50	40

	square feet	theater	classroom	conference	u-shape	reception	banquet
CONFERENCE LEVEL (4TH FLOOR)							
Rockefeller Boardroom	828	—	—	22	—	—	—
Willey	320	20	18	18	12	10	20
Stouffer Boardroom	846	—	—	26	—	—	—
Carnegie Boardroom	828	—	—	22	—	—	—
Blossom	576	50	20	24	22	50	30
Van Aken	760	85	48	36	30	50	60
Szell	252	20	9	12	9	10	10
Case, Garfield or Halle	558	50	20	22	19	30	30
Brush	425	24	16	16	15	20	20
Doan	208	20	9	8	9	10	10
Holden	510	40	20	16	19	20	30
Hopkins	418	35	15	16	12	20	20
Owens	306	20	9	12	9	10	10
Severance	2236	120	55	36	32	100	150

Hunter, Van Sweringen, Hamilton, Bryant, Scott, and Dandridge rooms accommodate up to 6 conference, 20 reception